

Series FF/ FH/ FU • Carbon Steel

Material	Carbon Steel
Surface Finishing	Zinc-Nickel, Zinc-Plating and Thick-Film-Passivation (Chrome III) only FF/FU 51
Standard Seal Material(s)	NBR (Buna-N®), PTFE, PU ²
Working Temperature	-25° C ... +100° C / -13° F ... +212° F
Valve Design	Flat Face
Connection	Push
Disconnection	Actuate Push Sleeve
Connect Under Pressure	not allowed, (Male Tip Series FU up to the max. Working Pressure allowed)
Application	Construction Machinery, Industrial Hydraulic
ISO Interchange	ISO 16028



²Alternative seal materials are available on request.

Technical Data

Series	BG	DN Zoll	DN metric ISO 4397	Q _{max}		Working Pressure*		Bursting Pressure Connected		Female Body		Male Tip		Spillage	
				l/min	US GPM	bar	PSI	bar	PSI	bar	PSI	bar	PSI	ml	fl oz
FF-06	1	1/4"	6,3	40	10.57	400	5802	1500	21756	1220	17695	2000	29008	0,01	.0003
FF-10	2	3/8"	10	80	21.13	350	5076	1100	15954	1100	15954	1500	21756	0,015	.0005
FF-12	3	1/2"	12,5	120	31.70	350	5076	1400	20305	1050	15229	1500	21756	0,02	.0007
FF-16	4A	5/8"	16	150	39.63	350	5076	1600	23206	1200	17405	1200	17405	0,02	.0007
FF-19	4	3/4"	19	200	52.83	350	5076	1200	17405	1100	15954	1300	18855	0,032	.0011
FF-25	5	1"	25	380	100.39	260	3771	1200	17405	820	11893	1040	15084	0,03	.0010
FF-38	6	1 1/2"	38	600	158.50	300	4351	1000	14504	1000	14504	1000	14504	0,155	.0052
FH-51	7	2"	51	1000	264.17	150	2176	650	9427	650	9427	700	10153	0,1	.0034
FU-10	2	3/8"	10	80	21.13	350	5076	1700	24656			1500	21756	0,015	.0005
FU-12	3	1/2"	12,5	120	31.70	350	5076	1500	21756			1400	20305	0,02	.0007
FU-19	4	3/4"	19	180	47.55	350	5076	1600	23206			1600	23206	0,032	.0011

The indicated pressure ratings only apply to the coupling itself and depend on the connection type.

Flow Characteristics

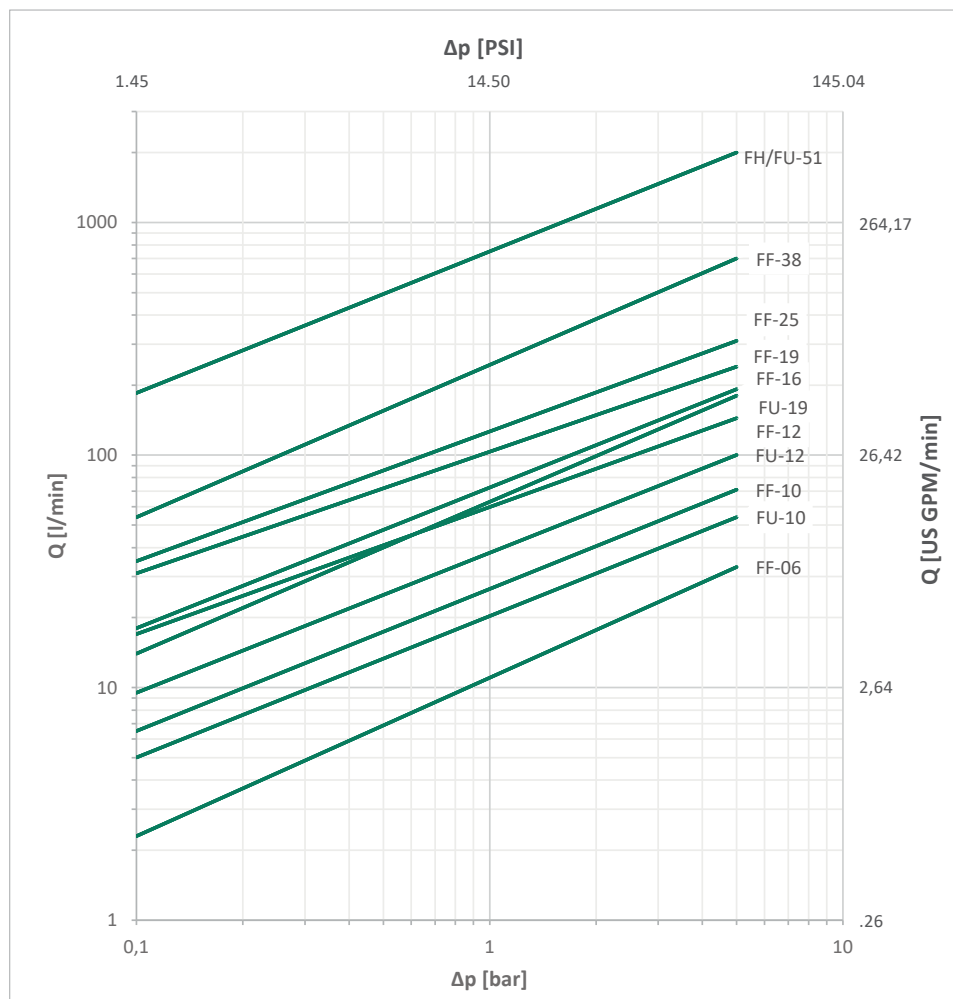

Please note: Unless otherwise stated, all flow characteristics have been determined with hydraulic oil with a kinematic viscosity of 28,8 - 35,2 mm²/s (28,8 - 35,2 cSt) and are only valid for components with non-reducing connections.



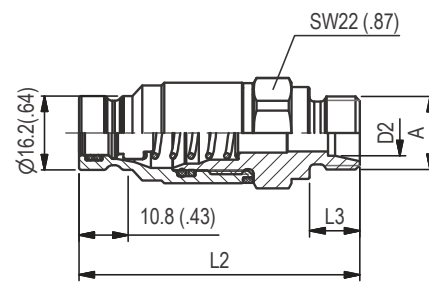
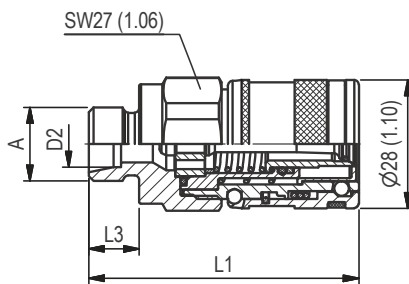

SW: Width across flats. All dimensions in mm (inch).

FF/FU
FH
Series FF-06 • BG 1 • Nominal Size 6,3

Port A	Dimensions (^{mm} / _{in})					Female Body Ordering Codes	Weight (^{kg} / _{lbs}) ca. per 100	Male Tip Ordering Codes	Weight (^{kg} / _{lbs}) ca. per 100
	ØD2	L1	L2	L3	L4				
Female Thread according to DIN 3852 - ISO 1179-1 - ANSI B 1.20.3 - SAE J1926-1 - ISO 11926-1									
	G 1/4"		55 2.17	54 2.13		12 .47	QRC-FF-06-F-G04-BT-W3 21,20 46.74	QRC-FF-06-M-G04-S1-W3 10,20 22.49	
	NPTF 1/4"-18		55 2.17	54 2.13			QRC-FF-06-F-NF04-BT-W3 22,10 48.72	QRC-FF-06-M-NF04-S1-W3 10,60 23.37	
	UNF 9/16"-18		55 2.17	52 2.05		12,8 .50	QRC-FF-06-F-U06-BT-W3 21,30 46.96	QRC-FF-06-M-U06-S1-W3 10,30 22.71	
Male Thread with 24° Conical Bore - Shape W according to DIN 3861									
	M14x1,5	8L	57 2.24	60 2.36	10 .39		QRC-FF-06-F-08L-BT-W3 18 39.68	QRC-FF-06-M-08L-S1-W3 10,20 22.49	
	M16x1,5	10L	59 2.32	61 2.40	11 .43		QRC-FF-06-F-10L-BT-W3 18,20 40.12	QRC-FF-06-M-10L-S1-W3 10,60 23.40	
Male Thread with 24° Conical Bore - Bulkhead - Shape W according to DIN 3861									
	M14x1,5	8L	73 2.87	75 2.95	25 .98		QRC-FF-06-F-08LB-BT-W3 19,40 42.77	QRC-FF-06-M-08LB-S1-W3 10,30 22.71	
	M16x1,5	10L	74 2.91	76 2.99	26 1.02		QRC-FF-06-F-10LB-BT-W3 20 44.09	QRC-FF-06-M-10LB-S1-W3 10,90 24.03	

Note: The connection of the two halves of a coupling is achieved depending on the type. It is important to observe the positive engagement of plug-type couplings and the secure tightening of screw-type couplings to the limit stop of the thread. Forced or improper separation will result in malfunction of the coupling.



FF/FU
FH

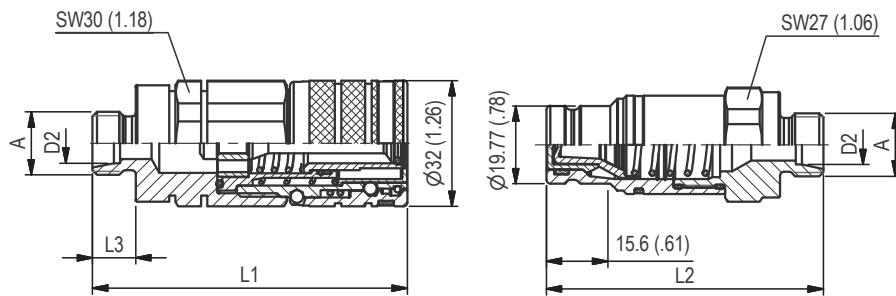

SW: Width across flats. All dimensions in mm (inch).

Series FF-10 ▪ BG 2 ▪ Nominal Size 10

Port A	Dimensions (^{mm} / _{in})					Female Body Ordering Codes	Weight (^{kg} / _{lbs}) ca. per 100	Male Tip Ordering Codes	Weight (^{kg} / _{lbs}) ca. per 100
	ØD2	L1	L2	L3	L4				
Female Thread according to DIN 3852-2 - ISO 6149-1 - ANSI B 1.20.3-SAE J1926-1 - ISO 11926-1									
	G 3/8"	69	59,9		14,2	QRC-FF-10-F-G06-BT-W3	28,50 62.83	QRC-FF-10-M-G06-BP-W3	12,70 28
	G 1/2"	69	64,9		14,2	QRC-FF-10-F-G08-BT-W3	27 59.52	QRC-FF-10-M-G08-BP-W3	12,10 26.68
	NPTF 3/8"-18	69	62,9			QRC-FF-10-F-NF06-BT-W3	28,70 63.27	QRC-FF-10-M-NF06-BP-W3	12,90 28.44
	NPTF 1/2"-14	70	62,9			QRC-FF-10-F-NF08-BT-W3	28 61.73	QRC-FF-10-M-NF08-BP-W3	13,70 30.20
	UNF 3/4"-16	69	63,9		14,3	QRC-FF-10-F-U08-BT-W3	27,50 60.63	QRC-FF-10-M-U08-BP-W3	13,80 30.42
		2.72	2.52		.56				
Male Thread with 24° Conical Bore - Shape W according to DIN 3861									
	M16x1,5	10L	80	70,4	11	QRC-FF-10-F-10L-BT-W3	30 66.14	QRC-FF-10-M-10L-BP-W3	14,70 32.41
			3.15	2.77	.43				
	M18x1,5	12L	80	70,4	11	QRC-FF-10-F-12L-BT-W3	30 66.14	QRC-FF-10-M-12L-BP-W3	14,70 32.41
			3.15	2.77	.43				
	M22x1,5	15L	81	71,4	12	QRC-FF-10-F-15L-BT-W3	30,70 67.68	QRC-FF-10-M-15L-BP-W3	15,20 33.51
			3.19	2.81	.47				
M20x1,5	12S	81	71,4	12	QRC-FF-10-F-12S-BT-W3	30,90 68.12	QRC-FF-10-M-12S-BP-W3	15,40 33.95	
		3.19	2.81	.47					
M24x1,5	16S	83	73,4	14	QRC-FF-10-F-16S-BT-W3	31,60 69.67	QRC-FF-10-M-16S-BP-W3	15,90 35.05	
		3.27	2.89	.55					
Male Thread with 24° Conical Bore - Bulkhead - Shape W according to DIN 3861									
	M16x1,5	10L	87	85,4	26	QRC-FF-10-F-10LB-BT-W3	28,6 62.92	QRC-FF-10-M-10LB-BP-W3	17 36.30
			3.43	3.36	1.02				
	M18x1,5	12L	87	85,4	26	QRC-FF-10-F-12LB-BT-W3	29 63.58	QRC-FF-10-M-12LB-BP-W3	17 36.96
			3.43	3.36	1.02				
	M22x1,5	15L	88	86,4	27	QRC-FF-10-F-15LB-BT-W3	31 67.32	QRC-FF-10-M-15LB-BP-W3	18 40.48
			3.46	3.40	1.06				
	M20x1,5	12S	88	86,4	27	QRC-FF-10-F-12SB-BT-W3	31 67.85	QRC-FF-10-M-12SB-BP-W3	19 40.81
			3.46	3.40	1.06				
	M24x1,5	16S	89,6	88,4	29	QRC-FF-10-F-16SB-BT-W3	32 71.28	QRC-FF-10-M-16SB-BP-W3	20 43.85
			3.53	3.48	1.14				

Note: The connection of the two halves of a coupling is achieved depending on the type. It is important to observe the positive engagement of plug-type couplings and the secure tightening of screw-type couplings to the limit stop of the thread. Forced or improper separation will result in malfunction of the coupling.



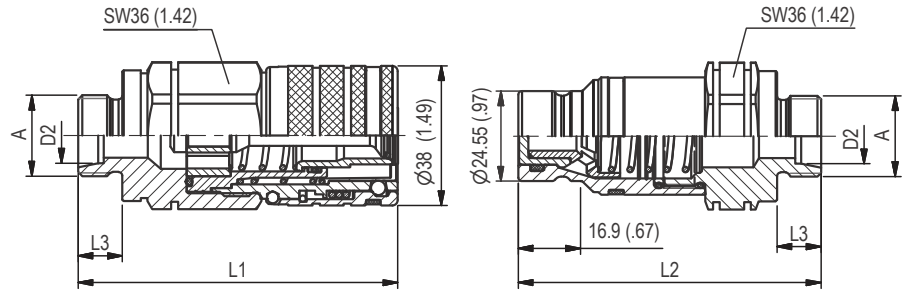

SW: Width across flats. All dimensions in mm (inch).

Series FF-12 ▪ BG 3 ▪ Nominal Size 12,5

Port A	Dimensions (^{mm} / _{in})					Female Body Ordering Codes	Weight (^{kg} / _{lbs}) ca. per 100	Male Tip Ordering Codes	Weight (^{kg} / _{lbs}) ca. per 100
	ØD2	L1	L2	L3	L4				
Female Thread according to DIN 3852-2 - ISO 6149-1 - ANSI B 1.20.3- SAE J1926-1 - ISO 11926-1									
	G 1/2"	84 3.31	71 2.80	14 .55		QRC-FF-12-F-G08-BT-W3	50 110.23	QRC-FF-12-M-G08-BP-W3	25,50 56.22
	G 3/4"	84 3.31	72 2.84	18 .71		QRC-FF-12-F-G12-BT-W3	46,60 102.74	QRC-FF-12-M-G12-BP-W3	23,50 51.81
	NPTF 1/2"-14	84 3.31	71 2.80			QRC-FF-12-F-NF08-BT-W3	50,70 111.77	QRC-FF-12-M-NF08-BP-W3	26 57.32
	NPTF 3/4"-14	84 3.31	72 2.84			QRC-FF-12-F-NF12-BT-W3	47,70 105.16	QRC-FF-12-M-NF12-BP-W3	24,10 53.13
	UNF 3/4"-16	84 3.31	72 2.83	14,3 .56		QRC-FF-12-F-U08-BT-W3	50,90 112.22	QRC-FF-12-M-U08-BP-W3	26,30 57.98
	UNF 7/8"-14	84 3.31	72 2.84	16,7 .66		QRC-FF-12-F-U10-BT-W3	49 108.03	QRC-FF-12-M-U10-BP-W3	25,30 55.78
	UN 1" 1/16-12	84 3.31	76 2.99	19 .75		QRC-FF-12-F-U12-BT-W3	45,60 100.53	QRC-FF-12-M-U12-BP-W3	24,50 54.01
	Male Thread with 24° Conical Bore - Shape W according to DIN 3861								
	M18x1,5	12L 3.39	86 3.21	11 .43		QRC-FF-12-F-12L-BT-W3	48,10 106.04	QRC-FF-12-M-12L-BP-W3	27,70 61.07
	M22x1,5	15L 3.43	87 3.25	12 .47		QRC-FF-12-F-15L-BT-W3	48,60 107.14	QRC-FF-12-M-15L-BP-W3	28,40 62.61
	M26x1,5	18L 3.43	87 3.25	12 .47		QRC-FF-12-F-18L-BT-W3	47,60 104.94	QRC-FF-12-M-18L-BP-W3	28,70 63.27
	M30x2	22L 3.50	89 3.33	14 .55		QRC-FF-12-F-22L-BT-W3	48,20 106.26	QRC-FF-12-M-22L-BP-W3	29,10 64.15
	M24x1,5	16S 3.50	89 3.33	14 .55		QRC-FF-12-F-16S-BT-W3	49,50 109.13	QRC-FF-12-M-16S-BP-W3	29,30 64.60
	M30x2	20S 3.58	91 3.41	16 .63		QRC-FF-12-F-20S-BT-W3	50,50 111.33	QRC-FF-12-M-20S-BP-W3	30,70 67.68
	Male Thread with 24° Conical Bore - Bulkhead - Shape W according to DIN 3861								
	M18x1,5	12L 3.58	94 3.70	26 1.02		QRC-FF-12-F-12LB-BT-W3	42,40 93.48	QRC-FF-12-M-12LB-BP-W3	28 61.73
	M22x1,5	15L 3.62	92 3.74	27 1.06		QRC-FF-12-F-15LB-BT-W3	44,20 97.44	QRC-FF-12-M-15LB-BP-W3	29,80 65.70
	M26x1,5	18L 3.62	92 3.74	27 1.06		QRC-FF-12-F-18LB-BT-W3	45,70 100.75	QRC-FF-12-M-18LB-BP-W3	31,30 69.00
	M30x2	22L 3.90	99 4.02	34 1.34		QRC-FF-12-F-22LB-BT-W3	48,70 107.37	QRC-FF-12-M-22LB-BP-W3	34,40 75.84
	M24x1,5	16S 3.70	94 3.82	29 1.14		QRC-FF-12-F-16SB-BT-W3	45,50 100.31	QRC-FF-12-M-16SB-BP-W3	31,60 69.67
	M30x2	20S 3.98	101 4.09	36 1.42		QRC-FF-12-F-20SB-BT-W3	51,50 113.54	QRC-FF-12-M-20SB-BP-W3	37,20 82.01

Note: The connection of the two halves of a coupling is achieved depending on the type. It is important to observe the positive engagement of plug-type couplings and the secure tightening of screw-type couplings to the limit stop of the thread. Forced or improper separation will result in malfunction of the coupling.



FF/FU
FH

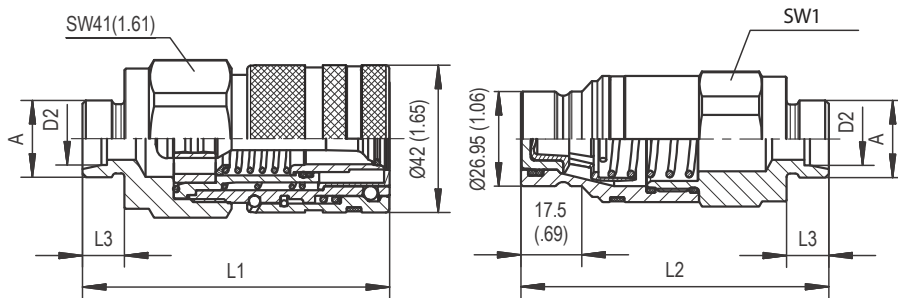

SW: Width across flats. All dimensions in mm (inch).

Series FF-16 ▪ BG 4A ▪ Nominal Size 16

Port A	Dimensions (mm/in)						Female Body	Weight (kg/lbs) ca. per 100	Male Tip	Weight (kg/lbs) ca. per 100
	ØD2	L1	L2	L3	L4	SW1	Ordering Codes		Ordering Codes	
Female Thread according to DIN 3852-2 - ANSI B 1.20.3 - SAE J1926-1 - ISO 11926-1										
	G 3/4"	87 3.43	73 2.87		16 .63	36 1.42	QRC-FF-16-F-G12-BT-W3	64,10 141.32	QRC-FF-16-M-G12-BP-W3	29,20 64.38
	G 1"	89 3.50	80 3.15		18 .71	41 1.61	QRC-FF-16-F-G16-BT-W3	66,90 147.49	QRC-FF-16-M-G16-BP-W3	28,50 62.83
	NPTF 3/4"-14	87 3.43	76 2.99			36 1.42	QRC-FF-16-F-NF12-BT-W3	66,90 147.49	QRC-FF-16-M-NF12-BP-W3	34,00 74.96
	UN 1" 1/16-12	87 3.43	78 3.07		19 .75	36 1.42	QRC-FF-16-F-U12-BT-W3	65,10 143.52	QRC-FF-16-M-U12-BP-W3	33,50 73.86
Male Thread with 24° Conical Bore - Shape W according to DIN 3861										
	M22x1,5	15L	87 3.43	88 3.46	12 .47	36 1.42	QRC-FF-16-F-15L-BT-W3	60,80 134.04	QRC-FF-16-M-15L-BP-W3	36,60 80.69
	M26x1,5	18L	87 3.43	88 3.46	12 .47	36 1.42	QRC-FF-16-F-18L-BT-W3	61,30 135.14	QRC-FF-16-M-18L-BP-W3	36,90 81.35
	M30x2	22L	89 3.50	90 3.54	14 .55	36 1.42	QRC-FF-16-F-22L-BT-W3	61,80 136.25	QRC-FF-16-M-22L-BP-W3	37,30 82.23
	M24x1,5	16S	89 3.50	90 3.54	14 .55	36 1.42	QRC-FF-16-F-16S-BT-W3	61,80 136.25	QRC-FF-16-M-16S-BP-W3	37,40 82.45
	M30x2	20S	91 3.58	92 3.62	16 .63	36 1.42	QRC-FF-16-F-20S-BT-W3	63,30 139.55	QRC-FF-16-M-20S-BP-W3	43,90 96.78
	M36x2	25S	93 3.66	94 3.70	18 .71	41 1.61	QRC-FF-16-F-25S-BT-W3	65,60 144.62	QRC-FF-16-M-25S-BP-W3	47,20 104.06
Male Thread with 24° Conical Bore - Bulkhead - Shape W according to DIN 3861										
	M22x1,5	15L	102 4.02	103 4.06	27 1.06	36 1.42	QRC-FF-16-F-15LB-BT-W3	63,60 140.21	QRC-FF-16-M-15LB-BP-W3	39,50 87.08
	M26x1,5	18L	102 4.02	103 4.06	27 1.06	36 1.42	QRC-FF-16-F-18LB-BT-W3	65,10 143.52	QRC-FF-16-M-18LB-BP-W3	41,10 90.61
	M30x2	22L	109 4.29	110 4.33	34 1.34	36 1.42	QRC-FF-16-F-22LB-BT-W3	68,10 150.14	QRC-FF-16-M-22LB-BP-W3	43,90 96.78
	M24x1,5	16S	104 4.09	105 4.13	29 1.14	36 1.42	QRC-FF-16-F-16SB-BT-W3	65,40 144.18	QRC-FF-16-M-16SB-BP-W3	41,40 91.27
	M30x2	20S	111 4.37	112 4.41	36 1.42	36 1.42	QRC-FF-16-F-20SB-BT-W3	71,00 156.53	QRC-FF-16-M-20SB-BP-W3	46,90 103.40
	M36x2	25S	113 4.45	114 4.49	38 1.50	41 1.61	QRC-FF-16-F-25SB-BT-W3	76,20 167.99	QRC-FF-16-M-25SB-BP-W3	58,20 128.31

Note: The connection of the two halves of a coupling is achieved depending on the type. It is important to observe the positive engagement of plug-type couplings and the secure tightening of screw-type couplings to the limit stop of the thread. Forced or improper separation will result in malfunction of the coupling.



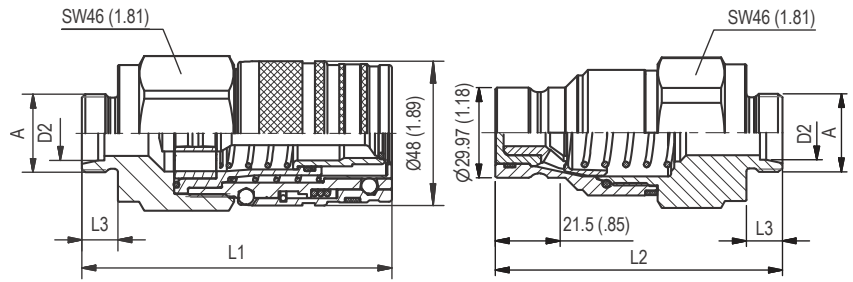

SW: Width across flats. All dimensions in mm (inch).

Series FF-19 • BG 4 • Nominal Size 19

Port A	Dimensions (mm/in)				Female Body Ordering Codes	Weight (^{kg} /lbs) ca. per 100	Male Tip Ordering Codes	Weight (^{kg} /lbs) ca. per 100
	ØD2	L1	L2	L3				
Female Thread according to DIN 3852-2 - ISO 6149-1 - ANSI B 1.20.3- SAE J1926-1 - ISO 11926-1								
	G 3/4"	99 3.89	84 3.31		16 .63	QRC-FF-19-F-G12-BT-W3 92,90 204.81	QRC-FF-19-M-G12-BP-W3 53,10 117.07	
	G 1"	99 3.89	84 3.31		18 .71	QRC-FF-19-F-G16-BT-W3 87,50 192.90	QRC-FF-19-M-G16-BP-W3 47,40 104.50	
	NPTF 3/4"-14	99 3.90	84 3.31			QRC-FF-19-F-NF12-BT-W3 94,40 208.12	QRC-FF-19-M-NF12-BP-W3 54,40 119.93	
	NPTF 1"-11 1/2	99 3.90	84 3.31			QRC-FF-19-F-NF16-BT-W3 90,50 199.52	QRC-FF-19-M-NF16-BP-W3 50,50 111.33	
	UN 1" 1/16-12	99 3.90	84 3.31		19 .75	QRC-FF-19-F-U12-BT-W3 93,10 205.25	QRC-FF-19-M-U12-BP-W3 53 116.85	
	UN 1" 5/16-12	99 3.90	84 3.31		19 .75	QRC-FF-19-F-U16-BT-W3 89,30 196.87	QRC-FF-19-M-U16-BP-W3 47,90 105.60	
	Male Thread with 24° Conical Bore - Shape W according to DIN 3861							
	M26x1,5	18L 4.06	103 3.76	96 4.7	12	QRC-FF-19-F-18L-BT-W3 91,10 200.84	QRC-FF-19-M-18L-BP-W3 60,70 133.82	
	M30x2	22L 4.14	105 3.84	98 4.55	14	QRC-FF-19-F-22L-BT-W3 91,10 200.84	QRC-FF-19-M-22L-BP-W3 59,80 131.84	
	M36x2	28L 4.14	105 3.84	98 4.55	14	QRC-FF-19-F-28L-BT-W3 90,30 199.08	QRC-FF-19-M-28L-BP-W3 58,10 128.09	
	M30x2	20S 4.22	107 3.92	100 4.63	16 .63	QRC-FF-19-F-20S-BT-W3 93,10 205.25	QRC-FF-19-M-20S-BP-W3 62,50 137.79	
	M36x2	25S 4.30	109 4.00	102 4.71	18 .71	QRC-FF-19-F-25S-BT-W3 94,70 208.78	QRC-FF-19-M-25S-BP-W3 63,20 139.33	
	M42x2	30S 4.38	111 4.07	104 4.79	20 .79	QRC-FF-19-F-30S-BT-W3 96,10 211.86	QRC-FF-19-M-30S-BP-W3 63,70 140.43	
Male Thread with 24° Conical Bore - Bulkhead - Shape W according to DIN 3861								
	M26x1,5	18L 4.93	125 4.63	118 1.34	34	QRC-FF-19-F-18LB-BT-W3 97,20 214.29	QRC-FF-19-M-18LB-BP-W3 66,80 147.27	
	M30x2	22L 4.93	125 4.63	118 1.34	34	QRC-FF-19-F-22LB-BT-W3 97,70 215.39	QRC-FF-19-M-22LB-BP-W3 66,50 146.61	
	M36x2	28L 4.93	125 4.63	118 1.34	34	QRC-FF-19-F-28LB-BT-W3 99,20 218.70	QRC-FF-19-M-28LB-BP-W3 67 147.71	
	M30x2	20S 5.09	129 4.70	120 1.42	36 1.42	QRC-FF-19-F-20SB-BT-W3 101,80 224.43	QRC-FF-19-M-20SB-BP-W3 70,40 155.21	
	M36x2	25S 5.09	129 4.86	124 1.50	38 1.50	QRC-FF-19-F-25SB-BT-W3 105,76 233.16	QRC-FF-19-M-25SB-BP-W3 74,30 163.80	
	M42x2	30S 5.17	131 4.86	124 1.50	38 1.50	QRC-FF-19-F-30SB-BT-W3 110,10 242.73	QRC-FF-19-M-30SB-BP-W3 77,80 171.52	

Note: The connection of the two halves of a coupling is achieved depending on the type. It is important to observe the positive engagement of plug-type couplings and the secure tightening of screw-type couplings to the limit stop of the thread. Forced or improper separation will result in malfunction of the coupling.



FF/FU
FH

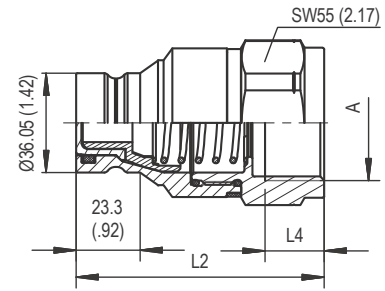
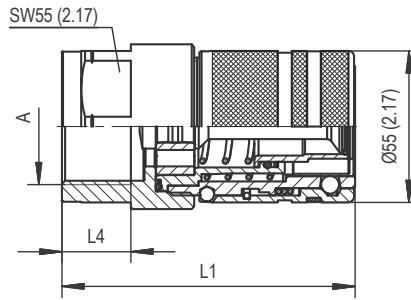

SW: Width across flats. All dimensions in mm (inch).

Series FF-25 ▪ BG 5 ▪ Nominal Size 25

Port A	Dimensions (^{mm} / _{in})					Female Body Ordering Codes	Weight (^{kg} / _{lbs}) ca. per 100	Male Tip Ordering Codes	Weight (^{kg} / _{lbs}) ca. per 100
	ØD2	L1	L2	L3	L4				
Female Thread according to DIN 3852-2 - ANSI B 1.20.3 - SAE J1926-1 - ISO 11926-1									
	G 1"	106	90		18	QRC-FF-25-F-G16-BT-W3	141,50	QRC-FF-25-M-G16-BP-W3	81,50
		4.17	3.54		.71		311.95		179.68
	G 1" 1/4	106	90		20	QRC-FF-25-F-G20-BT-W3	130,10	QRC-FF-25-M-G20-BP-W3	71,40
		4.17	3.54		.79		286.82		157.41
	G 1" 1/2	106	95,6		22	QRC-FF-25-F-G24-BT-W3	120,50	QRC-FF-25-M-G24-BP-W3	83,00
		4.17	3.76		.87		265.66		182.98
	NPTF 1" 11 1/2	106	90			QRC-FF-25-F-NF16-BT-W3	143,00	QRC-FF-25-M-NF16-BP-W3	83,00
		4.17	3.54				315.26		182.98
NPTF 1" 1/4-11 1/2	106	90			QRC-FF-25-F-NF20-BT-W3	133,70	QRC-FF-25-M-NF20-BP-W3	73,60	
	4.17	3.54				294.76		162.26	
UN 1" 5/16 - 12	106	90		19	QRC-FF-25-F-U16-BT-W3	140,50	QRC-FF-25-M-U16-BP-W3	80,80	
	4.17	3.54		.75		309.75		178.13	
UN 1" 5/8 - 12	106	90		19	QRC-FF-25-F-U20-BT-W3	132,10	QRC-FF-25-M-U20-BP-W3	72,00	
	4.17	3.54		.75		291.23		158.73	

Note: The connection of the two halves of a coupling is achieved depending on the type. It is important to observe the positive engagement of plug-type couplings and the secure tightening of screw-type couplings to the limit stop of the thread. Forced or improper separation will result in malfunction of the coupling.



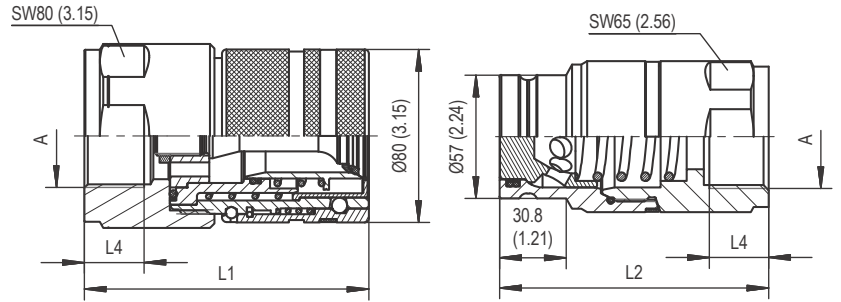

SW: Width across flats. All dimensions in mm (inch).

Series FF-38 • BG 6 • Nominal Size 38

Port A	Dimensions (mm/in)					Female Body Ordering Codes	Weight (^{kg} /lbs) ca. per 100	Male Tip Ordering Codes	Weight (^{kg} /lbs) ca. per 100
	ØD2	L1	L2	L3	L4				
Female Thread according to ISO 3852-2 - ANSI B 1.20.3 - SAE J1926-1 - ISO 11926-1									
	G 1 1/4"	131,6 5.18	124,6 4.91		21,5 .85	QRC-FF-38-F-G20-S1-W3	388,40 856.28	QRC-FF-38-M-G20-BT-W3	218,60 481.93
	G 1 1/2"	131,6 5.18	124,6 4.91		23 .89	QRC-FF-38-F-G24-S1-W3	379,10 835.77	QRC-FF-38-M-G24-BT-W3	209,90 462.75
	NPTF 1" 1/4- 11 1/2	131,6 5.18	124,6 4.91			QRC-FF-38-F-NF20-S1-W3	390,50 860.91	QRC-FF-38-M-NF20-BT-W3	221,10 487.44
	NPTF 1" 1/2- 11 1/2	131,6 5.18	124,6 4.91			QRC-FF-38-F-NF24-S1-W3	381,20 840.40	QRC-FF-38-M-NF24-BT-W3	216,80 477.96
	UN 1" 5/8-12	131,6 5.18	124,6 4.91		19 .75	QRC-FF-38-F-U20-S1-W3	387,70 854.73	QRC-FF-38-M-U20-BT-W3	218,50 481.71
	UN 1" 7/8-12	131,6 5.18	124,6 4.91		19 .75	QRC-FF-38-F-U24-S1-W3	376,10 829.16	QRC-FF-38-M-U24-BT-W3	210,30 463.63

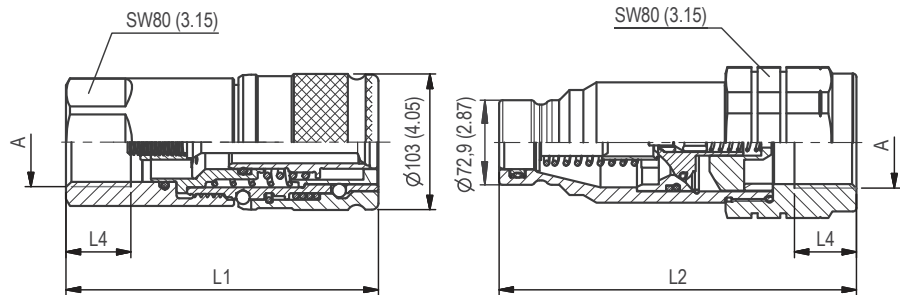

SW: Width across flats. All dimensions in mm (inch).

Series FH/FU 51 • BG 7 • Nominal Size 51

Port A	Dimensions (mm/in)					Female Body Ordering Codes	Weight (^{kg} /lbs) ca. per 100	Male Tip Ordering Codes	Weight (^{kg} /lbs) ca. per 100
	ØD2	L1	L2	L3	L4				
Female Thread according to DIN 3852-2-A - ANSI B 1.20.3									
	G 2"	147,4	173		24	QRC-FH-51-F-G32-BT-W66	550	QRC-FU-51-M-G32-BT-W66	489
		5,80	6,81		.94		1212.54		1078.06
	NPTF 2" -11 1/2	147,4	173			QRC-FH-51-F-NF32-BT-W66	540	QRC-FU-51-M-NF32-BT-W66	479
		5,80	6,81				1190.50		1056.01

Note: The connection of the two halves of a coupling is achieved depending on the type. It is important to observe the positive engagement of plug-type couplings and the secure tightening of screw-type couplings to the limit stop of the thread. Forced or improper separation will result in malfunction of the coupling.



FF/FU
FH

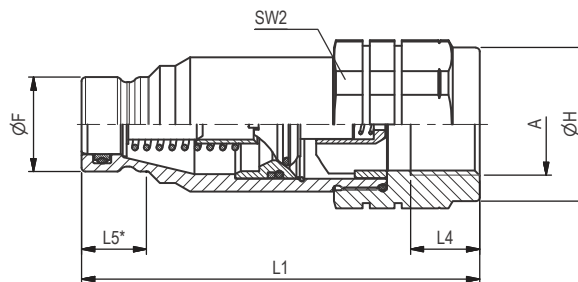

SW: Width across flats. All dimensions in mm (inch). Drawing similar Series FU-12.
* Insertion Male Tip

Series FU-10 • BG 2 • Nominal Size 10 • Connect Under Pressure

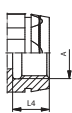
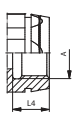
Port A	Dimensions (mm/in)						Male Tip Ordering Codes	Weight (kg/lbs) ca. per 100
	ØF	ØH	L1	L4	L5	SW2		
Female Thread according to DIN 3852-2								
 G 3/8"	19,79	29,3	87	12	15,6	30	QRC-FU-10-M-G06-BT-W3	24,10
	.78	1.17	3.43	.47	.61	1.18		53.13
 G 1/2"	19,79	29,3	90	14	15,6	30	QRC-FU-10-M-G08-BT-W3	24,60
	.78	1.17	3.54	.55	.61	1.18		54.23

Series FU-12 • BG 3 • Nominal Size 12,5 • Connect Under Pressure

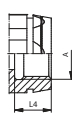
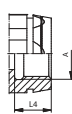
Port A	Dimensions (mm/in)						Male Tip Ordering Codes	Weight (kg/lbs) ca. per 100
	ØF	ØH	L1	L4	L5	SW2		
Female Thread according to DIN 3852-2								
 G 1/2"	24,58	40	98	14	16,9	41	QRC-FU-12-M-G08-BT-W3	49,20
	.97	1.57	3.86	.55	.67	1.61		108.47
 G 3/4"	24,58	40	104	16	16,9	41	QRC-FU-12-M-G12-BT-W3	51,10
	.97	1.57	4.09	.63	.67	1.61		112.66

Series FU-19 • BG 4 • Nominal Size 19 • Connect Under Pressure

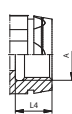
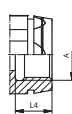
Port A	Dimensions (mm/in)						Male Tip Ordering Codes	Weight (kg/lbs) ca. per 100
	ØF	ØH	L1	L4	L5	SW2		
Female Thread according to DIN 3852-2								
 G 3/4"	30	45,5	114	16	21,5	46	QRC-FU-19-M-G12-BT-W3	82,60
	1.18	1.79	4.49	.63	.85	1.81		182.10
 G 1"	30	45,5	114	18	21,5	46	QRC-FU-19-M-G16-BT-W3	77,90
	1.18	1.79	4.49	.71	.85	1.81		171.74

Note: The connection of the two halves of a coupling is achieved depending on the type. It is important to observe the positive engagement of plug-type couplings and the secure tightening of screw-type couplings to the limit stop of the thread. Forced or improper separation will result in malfunction of the coupling.

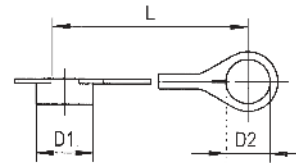
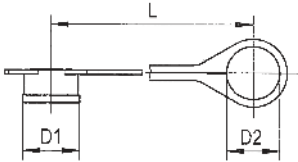

Series FH/FU/FF • Dust Protection

FF/FU
FH

Dimensions (mm/in)			Material	Dust Cap for Male Tip
D1	D2	L		Ordering Codes
28	24	170	Plastic (Colour: Red)	QRC-FF-06-DM-22-K-RD
1.10	.94	6.69		
32	27	115	Plastic (Colour: Red)	QRC-FF-10-DM-27-K-RD
1.26	1.06	4.53		
38	35,5	135	Plastic (Colour: Red)	QRC-FF-12-DM-36-K-RD
1.50	1.40	5.31		
42	30	220	Plastic (Colour: Red)	QRC-FF-16-DM-30-K-RD
1.65	1.18	8.66		
48	45,5	150	Plastic (Colour: Red)	QRC-FF-19-DM-46-K-RD
1.89	1.79	5.91		
46	51	290	Plastic (Colour: Red)	QRC-FF-25-DM-51-K-RD
1.81	2.01	11.42		

Dimensions (mm/in)			Material	Dust Plug for Female Body
D1	D2	L		Ordering Codes
34	24	170	Plastic (Colour: Red)	QRC-FF-06-DF-24-K-RD
1.34	.94	6.69		
38	30	130	Plastic (Colour: Red)	QRC-FF-10-DF-30-K-RD
1.50	1.18	5.12		
45	35,5	140	Plastic (Colour: Red)	QRC-FF-12-DF-36-K-RD
1.77	1.40	5.51		
46	30	225	Plastic (Colour: Red)	QRC-FF-16-DF-30-K-RD
1.81	1.18	8.86		
52	45,5	170	Plastic (Colour: Red)	QRC-FF-19-DF-46-K-RD
2.05	1.79	6.69		
62	51	290	Plastic (Colour: Red)	QRC-FF-25-DF-51-K-RD
2.44	2.01	11.42		

In addition to the standard colours as stated above,
 plastic dust caps are also available in blue, green, yellow and black.
 Please use the color codes BU, GN, YE and BK respectively instead of RD.

